



WELLHEAD
DISTRIBUTORS
INTERNATIONAL

API-6A Wellhead

Tubing Spools

WDI's WTCM tubing heads feature a versatile straight bore design for single and multiple completions. This design accepts all WTC series tubing hangers and easily converts from a single completion to multiple completions with the addition of a(n) alignment pin(s).

Features

Available Sizes

- Available with 7-1/16" nominal bowl compatible with 7-5/8" production casing

Straight bore design

- Features a 45° landing shoulder capable of supporting maximum loads

Outlets

- Line Pipe Outlets
- Studded Side Outlets

Manufacturing Standard

- API-6A, PSL-1, DD, L-U, PR-1 (3M & 5M)
- API-6A, PSL-2, DD, L-U, PR-1 (10M)

Tubing Hanger Compatibility

- WTCM tubing heads accept a wide variety of tubing hanger styles including mandrel and wrap around

Bottom Preparations

- PE/BG bottom for use with PE secondary seal (standard)
- HPE bottom, for use with HPE secondary seal bushing for high pressure applications

Availability

- Additional sizes available upon request
- Available with ET (integral) style lockscrews
- Flanged top tubing heads available with slip-on weld or threaded bottoms

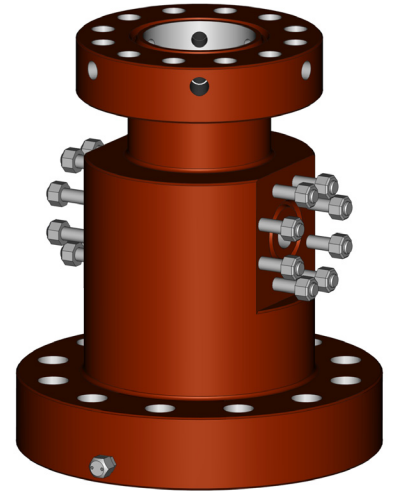



Tubing Spools

Specifications

Bottom Flange Size	Working Pressure	Top Flange Size	Working Pressure	Outlet	A	B	C	D	Approximate Weight	P/N
11"	2,000	7-1/16"	2,000	2"LP	16-3/4"	9-7/16"	7"	6/3/2008	440#	04-24062
11"	3,000	7-1/16"	3,000	2-1/16" Stdd	17"	9-3/4"	7"	6-3/8"	605#	04-24063
11"	3,000	7-1/16"	3,000	2-9/16" Stdd	17"	9-3/4"	7"	6/3/2008	635#	04-64063
11"	3,000	7-1/16"	5,000	2-1/16" Stdd	17"	10-7/8"	7"	6-13/16"	675#	04-23989
11"	3,000	7-1/16"	5,000	2-9/16" Stdd	17"	10-7/8"	7"	6-13/16"	725#	04-63989
11"	5,000	7-1/16"	5,000	2-1/16" Stdd	19"	10-7/8"	7"	6-13/16"	880#	04-88396
11"	5,000	7-1/16"	10,000	1-13/16" Stdd	19"	10-3/4"	7"	6-13/16"	1170#	04-36483
11"	10,000	7-1/16"	10,000	1-13/16" Stdd	24-1/4"	11"	7"	6-13/16"	1425#	04-44174
11"	10,000	7-1/16"	15,000	1-13/16" Stdd	26-1/2"	12-1/8"	7"	6-13/16"	1710#	04-36515



Tubing Spools

Specifications Cont.

Additional Sizes

Casing Size	Top Flange Size	Working Pressure	Outlet	A	B	C	D	Approximate Weight	P/N
4-1/2"	7-1/16"	2,000	2"LP	14"	7"	7"	6/3/2008	253#	02-00001
5-1/2"	7-1/16"	2,000	2"LP	14"	7"	7"	6-3/8"	243#	TBA
7"	7-1/16"	2,000	2"LP	14"	7"	7"	6/3/2008	233#	TBA
4-1/2"	7-1/16"	3,000	2"LP	14"	7"	7"	6-3/8"	275#	TBA
5-1/2"	7-1/16"	3,000	2"LP	14"	7"	7"	6-3/8"	264#	02-00002
7"	7-1/16"	3,000	2"LP	14"	7"	7"	6-3/8"	254#	TBA
4-1/2"	7-1/16"	5,000	2"LP	14-1/2"	9"	7"	6-3/8"	325#	TBA
5-1/2"	7-1/16"	5,000	2"LP	14-1/2"	9"	7"	6-3/8"	305#	TBA
7"	7-1/16"	5,000	2"LP	14-1/2"	9"	7"	6/3/2008	295#	TBA