



WELLHEAD
DISTRIBUTORS
INTERNATIONAL

API-6A Wellhead

Intermediate Spools

WDI's WC-22 casing spools feature a versatile straight bore design that can accept a wide variety of slip and mandrel type casing hangers.

Features

- Features a 45° landing shoulder capable of supporting maximum loads
- Prevents test plugs from wedging under pressure

Outlets

- Line Pipe Outlets
- Studded Side Outlets

Casing Hanger Compatibility

- WC-21 and WC-22 slip-type casing hangers
- Mandrel style casing hangers

Manufacturing Standard

- API-6A, PSL-1, DD, L-U, PR-1

Availability

- Additional sizes available upon request
- Available in WC-29 profile upon request

Lock screws

- WC-22-BP casing heads are supplied with (2) lockscrews for wear bushing retention
- WC-22-L and WC-29-L casing head are supplied with a full set of lockscrews for mandrel casing hanger and packoff retention

Bottom Preparations

- PE/BG bottom for use with PE secondary seal (standard)
- HPE bottom, for use with HPE secondary seal bushing for high pressure applications
- Integral P or S seals

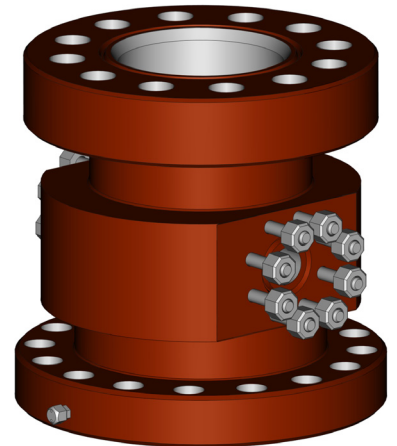



Intermediate Spools

Specifications

Bottom Flange Size	Working Pressure	Top Flange Size	Working Pressure	Outlet	A	B	C	D	Approximate Weight	P/N
11"	3,000	11"	3,000	2-1/16"Stdd	20-5/8"	10-1/4"	10-7/8"	10"	755#	03-93012
11"	3,000	11"	5,000	2-1/16"Stdd	22-1/4"	12-3/4"	10-7/8"	10"	835#	N/A
11"	5,000	11"	5,000	2-1/16"Stdd	23-7/8"	12-3/4"	10-7/8"	10"	910#	03-89012
11"	5,000	11"	10,000	1-13/16"Stdd	24-3/4"	13-5/8"	10-7/8"	10"	1210#	03-89375
11"	10,000	11"	10,000	1-13/16"Stdd	25-5/8"	14-1/2"	10-7/8"	10"	1410#	N/A
13-5/8"	3,000	11"	3,000	2"LP	22-5/8"	10-1/4"	10-7/8"	10"	680#	03-43336
13-5/8"	3,000	11"	3,000	2-1/16"Stdd	22-5/8"	10-1/4"	10-7/8"	10"	799#	03-43338
13-5/8"	3,000	11"	5,000	2"LP	25-1/4"	12-3/4"	10-7/8"	10"	1140#	03-98876
13-5/8"	3,000	11"	5,000	2-1/16"Stdd	25-1/4"	12-3/4"	10-7/8"	10"	1168#	03-98870
13-5/8"	5,000	11"	5,000	2-1/16"Stdd	25-1/8"	12-3/4"	10-7/8"	10"	1430#	03-36066
13-5/8"	5,000	11"	10,000	1-13/16"Stdd	26"	13-1/2"	10-7/8"	10"	1631	03-89371
21-1/4"	2,000	13-5/8"	3,000	2-1/16"Stdd	26-3/4"	10-5/8"	13-1/2"	12-1/2"	1755#	N/A
20-3/4"	3,000	13-5/8"	3,000	1-13/16"Stdd	27-5/8"	10-5/8"	13-1/2"	12-1/2"	1855#	N/A
20-3/4"	3,000	13-5/8"	5,000	2-1/16"Stdd	28-5/8"	12-1/8"	13-1/2"	12-3/8"	1950#	N/A