



WELLHEAD  
DISTRIBUTORS  
INTERNATIONAL

*API-6A Wellhead*

## *Casing Heads*

WDI's WC-22 casing heads feature a versatile straight bore design that can accept a wide variety of slip and mandrel type casing hangers.

### *Features*

- Features a 45° landing shoulder capable of supporting maximum loads
- Prevents test plugs from wedging under pressure

### **Outlets**

- Line Pipe Outlets
- Studded Side Outlets

### **Casing Hanger Compatibility**

- WC-21 and WC-22 slip-type casing hangers
- Mandrel style casing hangers

### **Manufacturing Standard**

- API-6A, PSL-1, DD, L-U, PR-1

### **Availability**

- Additional sizes available upon request
- Available in WC-29 profile upon request

### **Lock screws**

- WC-22-BP casing heads are supplied with (2) lockscrews for wear bushing retention
- WC-22-L and WC-29-L casing head are supplied with a full set of lockscrews for mandrel casing hanger and packoff retention

### **Bottom Connections**

- Slip-on weld
- Slip-on weld with o-ring
- Threaded

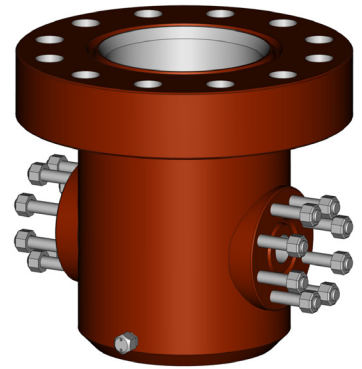



## Casing Heads

### Specifications

| Flange Size | Working Pressure | Casing Size | A   | B       | C       | D       | Approximate Weight | P/N SOW Btm | P/N Female Threaded Btm |
|-------------|------------------|-------------|-----|---------|---------|---------|--------------------|-------------|-------------------------|
| 11"         | 2,000            | 9-5/8"      | 17" | 10-1/8" | 10-7/8" | 9"      | 505#               | 01-CB012    | N/A                     |
| 11"         | 3,000            | 8-5/8"      | 17" | 10-1/8" | 10-7/8" | 8"      | 535#               | 01-08355    | 01-08400                |
| 11"         | 3,000            | 9-5/8"      | 17" | 10-1/8" | 10-7/8" | 9"      | 525#               | 01-00014    | N/A                     |
| 11"         | 3,000            | 10-3/4"     | 17" | 10-1/8" | 10-7/8" | 10"     | 490#               | 01-00016    | N/A                     |
| 11"         | 5,000            | 8-5/8"      | 17" | 10-1/2" | 10-7/8" | 8"      | 685#               | 01-15118    | 01-00221                |
| **11"       | 5,000            | 9-5/8"      | 17" | 10-1/2" | 10-7/8" | 9"      | 680#               | 01-15120    | N/A                     |
| 11"         | 5,000            | 10-3/4"     | 17" | 10-1/2" | 10-7/8" | 10"     | 670#               | 01-15121    | N/A                     |
| 13-5/8"     | 3,000            | 13-3/8"     | 17" | 10-1/4" | 13-1/2" | 12-1/2" | 570#               | 01-08252    | N/A                     |
| **13-5/8"   | 5,000            | 13-3/8"     | 19" | 10-1/4" | 13-1/2" | 12-3/8" | 1000#              | 01-08253    | N/A                     |
| 21-1/4"     | 2,000            | 20"         | 20" | 10-1/4" | 21-1/8" | 19"     | 1050#              | N/A         | N/A                     |
| 20-3/4"     | 3,000            | 20"         | 23" | 15"     | 20-1/8" | 19"     | 1322#              | N/A         | N/A                     |